



JAPAN AUTOMOBILE FEDERATION F.I.A. Homol. No

1444 1/ET

FEDERATION INTERNATIONALE DE L'AUTOMOBILE

Amendment to Form of Recognition in accordance with the International Sporting Code.

Make HINO MOTORS, LTD.

Model Contessa 1300 Coupe L

Modification's application starts with serial

No. chassis PD300-101211 engine GR100-101575

Application of this amendment started the December 1, 1965

Commercial denomination after application of modifications

F.I.A. Recognition No. 1444 Groupe 2-Touring

The modifications are to be considered as: ~~XXXX~~ normal evolution of the type

Date amendment is valid from 1/4/67 List 16/1

Description of amendment

INLET

Item, 181. Diameter of valves 38mm .51inches

EXHAUST (Photograph Q) Q. exhaust manifold

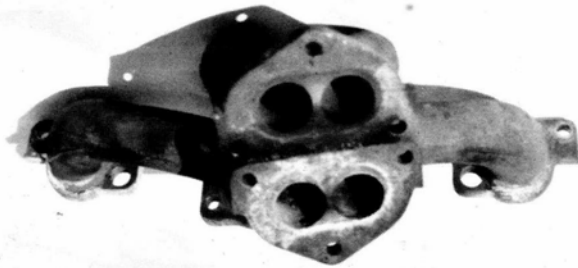

30φxx

Stamp and signature of National Sporting Authority

JAPAN AUTOMOBILE FEDERATION

Handwritten signature in Japanese: 難波靖広

Yasuharu Nanba

Stamp and signature of F.I.A.

Handwritten signature of F.I.A. official



Drawing exhaust manifold ports, side of cylinderhead.

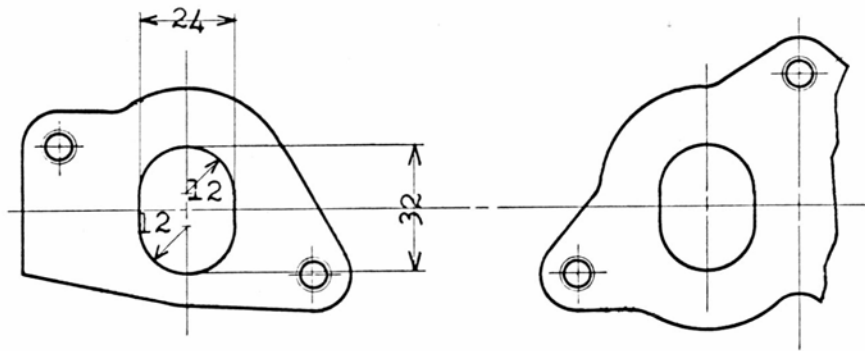

Drawing of exit to exhaust port of cylinderhead.

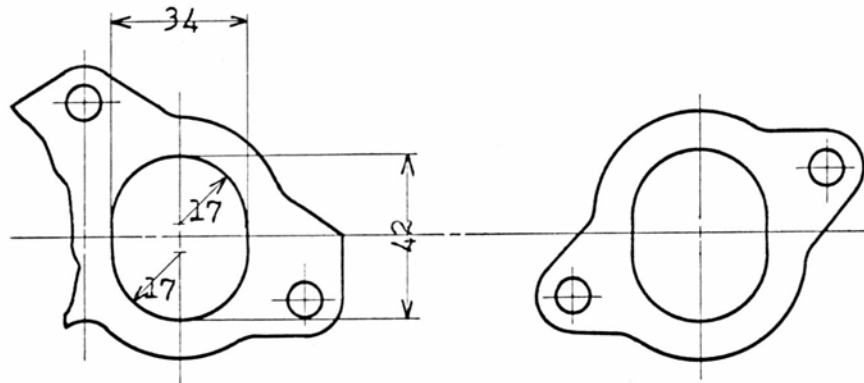

Dimension ; mm
General tolerance +1.2
-0.5



JAPAN AUTOMOBILE FEDERATION

F. I. A. Homol. No 1444 A/V

FEDERATION INTERNATIONALE DE L'AUTOMOBILE

Amendment to Form of Recognition in accordance with the International Sporting Code.

Make HINO MOTORS, LTD. Model Contessa 1300 Coupe L
Modification's application starts with serial No. chassis PD300-101211 engine GR100-101575
Application of this amendment started the December 1, 1965
Commercial denomination after application of modifications F.I.A. Recognition No.1444
The modifications are to be considered as: Variant / ~~XXXXXXXXXXXX~~ Groupe 2-Touring
Date amendment is valid from 1/4/67 List 10/11

Description of amendment

Another Type of GEAR BOX

Item, 271. No. of gear-box ratios forward 5
Item, 272. Synchronized forward ratios 4 (2,3,4,5)

Table with 3 columns: 277., Manual Ratio, No. teeth. Rows include 1, 2, 3, 4, 5, and reverse with their respective ratios and gear teeth.

Stamp and signature of National Sporting Authority

JAPAN AUTOMOBILE FEDERATION

Stamp and signature of F. I. A.

Handwritten signature of F.I.A. official

Handwritten signature Yasuharu Nanba

Yasuharu Nanba





JAPAN AUTOMOBILE FEDERATION F. I. A. Homol. No

1444 B/U

FEDERATION INTERNATIONALE DE L'AUTOMOBILE

Amendment to Form of Recognition
in accordance with the International
Sporting Code.

Make HINO MOTORS, LTD. **Model** Contesa 1300 Coupe L
 Modification's application starts with serial **chassis** PD300-101211
 No. **engine** GR100-101575
 Application of this amendment started the **December 1, 1965**
 Commercial denomination after application of modifications **F.I.A. Recognition No.1444**
 The modifications are to be considered as: Variant/ ~~XXXXXX~~ ~~XXXXXX~~ ~~XXXXXX~~ ~~XXXXXX~~ ~~XXXXXX~~ ~~XXXXXX~~ ~~XXXXXX~~ ~~XXXXXX~~ ~~XXXXXX~~ ~~XXXXXX~~ **Groupe 2-Touring**
 Date amendment is valid from **1/7/67** List **16/4**

Description of amendment

Optional parts.

- Item No.7. Capacity of fuel tank 45l trs 11.5 Gallon US
- Item No.292. Type of limited slip differential Friction

Stamp and signature of
National Sporting Authority

JAPAN AUTOMOBILE FEDERATION

難波靖治

Yasuharu Nanba

Stamp and signature of F. I. A.

[Handwritten signature]

